

MODULARITY

Measurements

Wall to wall widths:
315 - 473 - 630 - 945 - 1260 - 1417 - 1890 + 28 mm for end piece
12 3/8" - 18 5/8" - 24 7/8" - 37 1/4" - 49 5/8" - 55 3/4" - 74 3/8" + 1 1/8"

Heights:
397 - 717 - 1037 - 1357 - 1677 - 1997 - 2317 - 2637 - 2957 mm
15 5/8" - 28 1/4" - 40 7/8" - 53 3/8" - 66" - 78 5/8" - 91 1/4" - 103 7/8" - 116 3/8"

Structure depth:
304 - 400 - 540 mm (12" - 15 3/4" - 21 1/4")

Depth with pressure opening th 40 (1 5/8") / glass doors with shaped profile:
348 - 444 - 584 mm (13 3/4" - 17 1/2" - 23")

Depth with pressure opening or handle th 22 (7/8"):
330 - 426 - 566 mm (13" - 16 3/4" - 22 1/4")

Notes

A minimum extra height space of 30 mm (1 1/8") is required for installation purposes; the same applies for the width if placed in a niche. Reductions in the three dimensions (width, height and depth) are done to the millimetre. In all cases, the reduction will be charged to the Client.

The minimum width is 315 mm (12 3/8"), therefore no reductions is forseen for units of 315 mm (12 3/8").

- No reduction possible for:
 - Internal and external drawers
 - Sliding doors
 - Glass hinged doors
 - Vertical sliding doors
 - Flap doors th 40 (1 5/8")
 - Hinged doors th 40 (1 5/8")
 - TV compartment D 400 (15 3/4")
 - Modules W 1417 (55 3/4") and 1890 (74 3/8") in width and depth

Heights and depth of the units resting on the floor

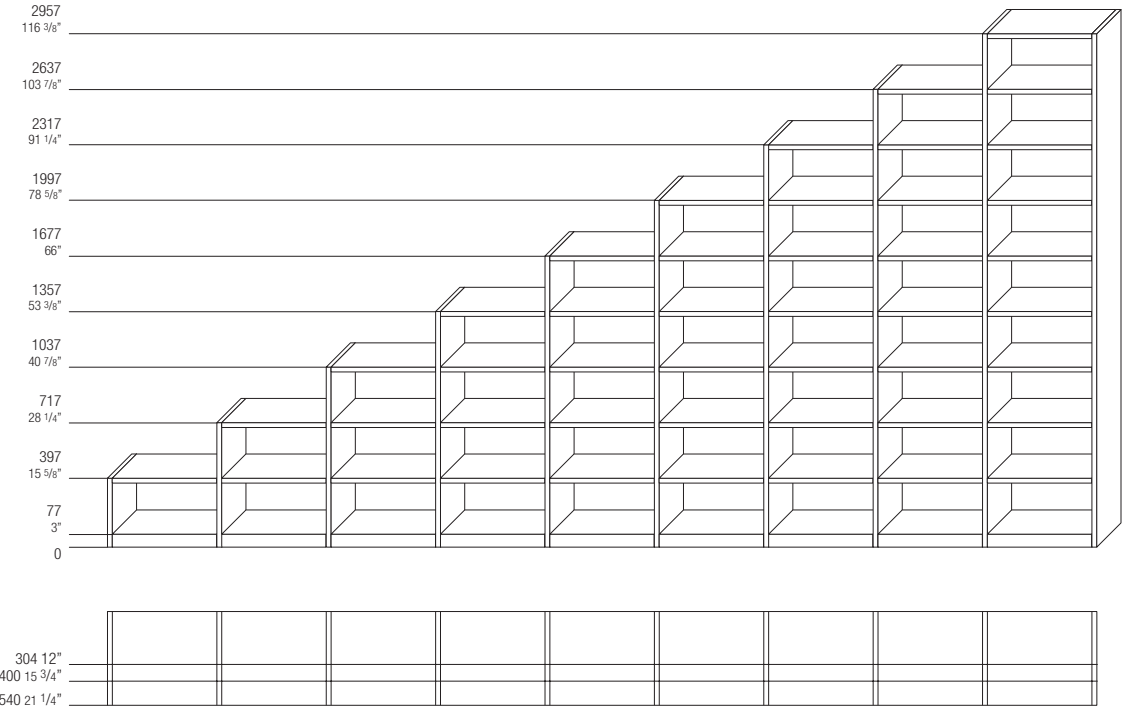

DATASHEET

REGISTERED
DESIGN

IX.2019

FINISHES

Wood grain

Pressure opening th 40

- HORIZONTAL GRAIN for vertical sliding doors, drawers and flap doors
- HORIZONTAL AND VERTICAL GRAIN for hinged and sliding doors

Pressure opening th 22

- HORIZONTAL GRAIN for drawers
- VERTICAL GRAIN for hinged doors

Handle opening th. 22

- HORIZONTAL GRAIN for drawers
- VERTICAL GRAIN for hinged doors

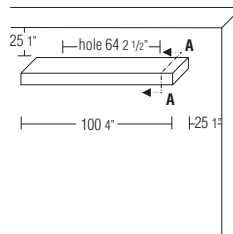

type B

handle opening th 22 (7/8")
(always horizontally positioned).
Upon request can be mounted on a vertical sliding door (see pg. 34/35 of the price list)

section A-A



finishes:
- black chrome
- pewter colour
- zinc

finishes	matt lacquer colours	glossy lacquer colours	woods	special woods	transparent glass	coloured glass	coloured etched glass	zinc/ pewter colour	Eco Skin	Stopsol glass	fine grain	black chrome	net glass
components													
structure and plinth													
mobile partitions									"L-shaped"				
backs													
rear finishing panels													
internal drawer units													
door opening th. 40 (hinged/ flap/vertical sliding)													
doors/external drawers with handle or pressure opening th. 22													
glass doors (hinged/ vertical sliding)	trims												
	glass				hinged					vertical sliding/hinged			hinged
shelves													
tops													
protruding shelves D 540													
backs for TV													
central partition	trim												
glass divider and glass shelves	glass												

colours

Matt lacquer

BC chalk white
PE pearl
DN dune
PL platinum
NE black
AT anthracite
SE mustard
SI silica
DO dolomite grey
AL clay
MK moka
CM caramel
CZ light blue grey
SA sand
RU ruby
RE rust
PX pewter colour
RX copper
TO dove grey

Glossy lacquer

BC chalk white
PE pearl
DN dune
PL platinum
NE black
AT anthracite
SE mustard
SI silica
DO dolomite grey
AL clay
MK moka
CM caramel
CZ light blue grey
SA sand
RU ruby
RE rust
PX pewter colour
RX copper
TO dove grey

Woods

EU eucalyptus
RG grey oak
RF graphite oak

Special woods

NO walnut

Coloured glass

BC chalk white
PE pearl
DN dune
PL platinum
NE black
AT anthracite
SE mustard
SI silica
DO dolomite grey
AL clay
MK moka
CM caramel
CZ light blue grey
SA sand
RU ruby
RE rust
PX pewter colour
RX copper
TO dove grey

Coloured etched glass

BC chalk white
PE pearl
DN dune
PL platinum
NE black
AT anthracite
SE mustard
SI silica
DO dolomite grey
AL clay
MK moka
CM caramel
CZ light blue grey
SA sand
RU ruby
RE rust
PX pewter colour
RX copper
TO dove grey

Eco Skin

grey
mink
hemp
ivory
dark brown

DATASHEET

REGISTERED
DESIGN

IX.2019

TECHNICAL INFORMATION

SIDES, SHELVES TH. 28, BACKS, TV BACKS

Chipboard covered with Oak (Quercus), Eucalyptus (Eucalyptus globulus) or melamine painted in colours from the Molteni range.

GLASS SIDE PANELS

Tempered crystal, thickness 8 mm with front profile in painted extruded aluminium.

ALUMINIUM/REINFORCED SHELF

Composite panel with internal frame in wood particles, filler in the structural PVC foam and 1mm aluminium sheet, covered in wood veneer in Eucalyptus or Oak, or melamine facing painted in Molteni Range colours. For panels 1231 in width, the panel is in honeycomb with internal reinforcement bars in iron.

FINE GRAIN BACK PANEL

Chipboard coated with cylinder etched coextruded sheet of ABS-PMMA, painted in specific Molteni finish.

BASEBOARD

Anodised extruded aluminium painted in colours from the Molteni range or covered with Oak or Eucalyptus.

WOODEN DOORS TH. 22 AND EXTERNAL DRAWER FRONT TH. 22

Chipboard covered with Oak, Walnut (Juglans nigra), Eucalyptus or melamine painted in colours from the Molteni Range.

DOOR AND DRAWER FRONT TH. 40

Honeycomb or chipboard panel covered with wood veneer in Oak, Walnut, Eucalyptus, or melamine facing painted in Molteni Range colours.

GLASS DOORS

Frame in painted extruded aluminium. Tempered crystal, thickness 5 mm in the finishes from the Molteni Range.

PROTUDING SHELF

Chipboard panel covered in wood veneer in Eucalyptus or Oak, or with Eco Skin in Molteni Range colours. Perimeter profile in extruded aluminium painted in Molteni Range colours. If used out of composition, the shelf has metal brackets for fastening to the wall.

DIVIDERS

Chipboard panel in box-structure wood covered in wood veneer in Eucalyptus, Oak, Walnut, or melamine facing painted in Molteni Range colours, or in artificial leather in Molteni Range colors. Caps in moulded plastic with coextruded rubber profiles.

WOODEN TOP TH. 10

MDF covered with Oak, Walnut, Eucalyptus sliced wood or melamine covered, painted in colours from the Molteni Range.

GLASS TOP TH. 10

Tempered glass th. 10mm painted in Molteni Range colours.

INSIDE DRAWER BOTTOM AND SIDES

Chipboard covered with melamine.

HANDLES AND WIRE HOLE

In several materials and finishes available.

GLASS SHELVES

Tempered crystal, thickness 8 mm., transparent or painted extruded aluminium with tempered crystal, thickness mm 4.

BRIDGE BAR

Anodised extruded aluminium (several finishes).

Molteni & C

FINISHES MOLteni&C RANGE

IX.2018

	MATT LACQUER	GLOSSY LACQUER	COLOURED GLASS	ETCHED COLOURED GLASS	CARTAPAGLIA LACQUERED only Gliss Master	STOPSOL GLASS TRANSPARENT STOPSOL GLASS
CHALK WHITE	•	•	•	•	•	
PEARL	•	•	•	•	•	
SILICA	•	•	•	•	•	
SAND	•	•	•	•	•	
DOVE GREY	•	•	•	•	•	
PLATINUM	•	•	•	•	•	
DUNE	•	•	•	•	•	
CLAY	•	•	•	•	•	
DOLOMITE GREY	•	•	•	•	•	
COPPER	•	•	•	•	•	
RUST	•	•	•	•	•	
RUBY	•	•	•	•	•	
CARAMEL	•	•	•	•	•	
MOKA	•	•	•	•	•	
MUSTARD	•	•	•	•	•	
LIGHT BLUE GREY	•	•	•	•	•	
PEWTER COLOUR	•	•	•	•	•	
ANTHRACITE	•	•	•	•	•	
BLACK	•	•	•	•	•	
STOPSOL						•
LESSLESS RED	•					
only matt lacquer						

Molteni & C

FINISHES MOLTENI&C RANGE

IX.2018

WOODS

EUCALYPTUS

AMERICAN WALNUT

GRAPHITE OAK

GREY OAK

BLACK OAK

WALNUT

CEDAR

ASH WOOD IN NATURAL COLOUR

ASH WOOD STAINED BLACK

MARBLES

WHITE CARRARA

RED LAGUNA

EMPERADOR DARK

BLACK MARQUINA

ORIENT GREY

SAHARA NOIR

CALACATTA GOLD

METAL PARTS

BLACK CHROME

SHINY ALUMINIUM

PEWTER COLOUR

COPPER

BRONZE

DWELL
DOOR FRAME, TRACK COVERING PROFILES

ANODISED ALUMINIUM

BROWN ALUMINIUM

The finishes shown are indicative and refer to the entire production range. We recommend that you consult the "Colour Range" samples which shown the complete range of finishes, including those not shown here. Molteni&C reserves the right to modify the range without warning.

Molteni & C

FINISHES MOLTENI&C RANGE

IX.2018

MELAMINE FRONT
GLISS MASTER

CARTAPAGLIA WHITE



CARTAPAGLIA ANTHRACITE



CARTAPAGLIA SILICA



GRAFFIATO SILICA



GRAFFIATO BRONZE



SILK DOVE GREY



SILK SILICA



SILK CHALK WHITE



MELAMINE STRUCTURE
GLISS MASTER

WHITE SHANTUNG



GREY SHANTUNG



MELAMINE STRUCTURE
GLISS MASTER, MASTER DRESSING,
GLISS WALK-IN

SILVER CEMBRAN



LARIX DARK

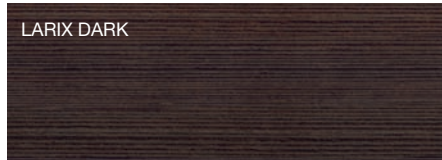

MELAMINE STRUCTURE
GLISS MASTER, MASTER DRESSING

WHITE



ECO SKIN

IVORY



HEMP



MINK



DARK BROWN

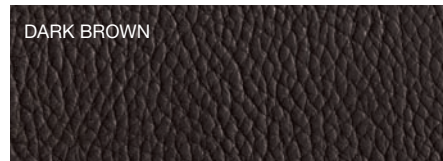

GREY



FINE GRAIN

FINE GRAIN

